



Electrolux
PROFESSIONAL

Handling System for Rack Type Tray Lowerator for Conveyor - H=1200/1300mm

ITEM # _____

MODEL # _____

NAME # _____

SIS # _____

AIA # _____

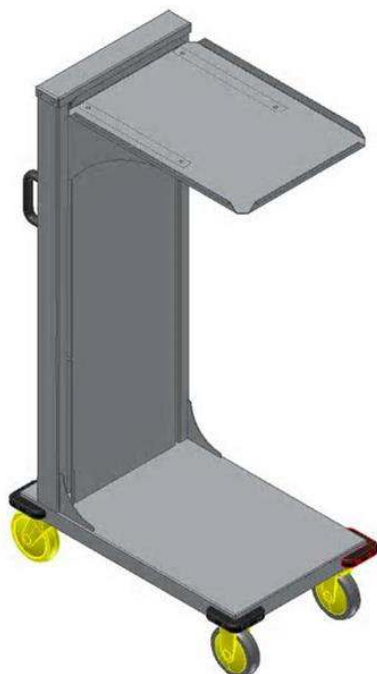

865136 (HSTL1200)

Tray lowerator for conveyor,
H=1200/1300mm

Short Form Specification

Item No. _____

Constructed in 304 AISI stainless steel. One lower platform shelf and one upper lowerator shelf. The automatic lifting system for the upper shelf can easily be adjusted for different weights of items by means of adding or removing springs. The easy accessible springs are located behind the interior front plate. Four heavy duty swivelling castors 125mm, 2 with brake. Durable no-mark tread on the castors. Suitable to be used at the end of a tray conveyor to collect empty trays from the drive unit with tray unloader. Lowerator shelf size 538x385mm. Discharge height: 1200-1300mm. Supplied with one set of 4 corner bumpers.

Main Features

- Automatic lifting system for upper shelf sustains different weights of items by means of adding or removing springs, that is located behind the interior front plate.

Construction

- AISI 304 stainless steel with smooth, easy to clean surfaces.
- Durable no-mark tread on the wheels.

APPROVAL: _____



Experience the Excellence
www.electroluxprofessional.com
professional@electrolux.com



Electrolux
PROFESSIONAL

Handling System for Rack Type Tray Lowerator for Conveyor - H=1200/1300mm

Front

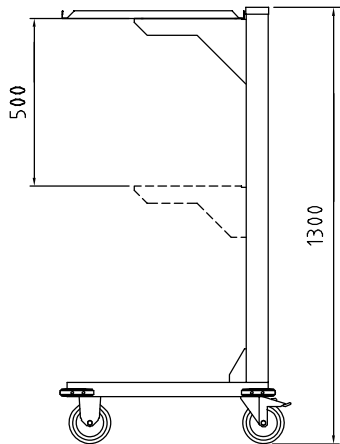

Top

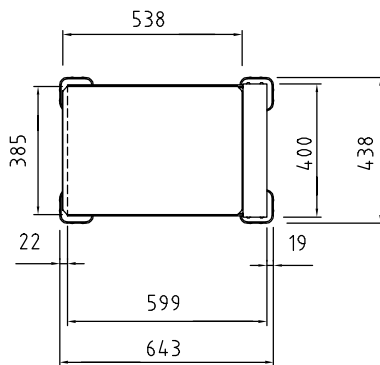

Side

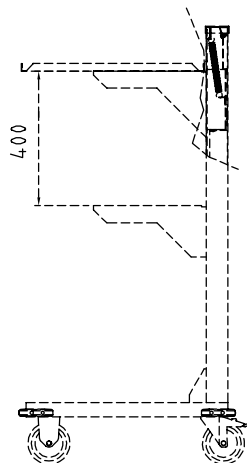

Key Information:

External dimensions, Width:

865136 (HSTL1200) 438 mm

External dimensions, Depth: 643 mm

External dimensions, Height: 1300 mm

Net weight: 40 kg

Handling System for Rack Type
Tray Lowerator for Conveyor - H=1200/1300mm

The company reserves the right to make modifications to the products
without prior notice. All information correct at time of printing.

2024.04.23